

Lykomitros
STEEL Constructions

steel S.A
tel.: 24210 96739



Proven track record of on-time and within the budget projects

LYKOMITROS STEEL- founded in 2006- is continuously expanding, implementing numerous projects in the domestic and global market.

We collaborate with some of the biggest construction companies globally and about 80 to 90% of turnover comes from export activity.

Our company delivers with the highest quality standards: we are a customer-oriented organization placing satisfaction at the core of our business decisions and project making.



TUV HELLAS
Member of TUV NORD Group

CERTIFICATE

Management system as per
EN ISO 9001 : 2008
Quality Management Systems - Requirements

In accordance with TUV HELLAS (TUV NORD) S.A. procedures, it is hereby certified that

LYKOMITROS STEEL S.A.
Ano Spartia, Sesklo Magnisias
385 00 Volos
Hellas

applies a Management System in line with the above standard for the following scope

Fabrication and Installation of Steel Constructions.

Certificate Registration No. 041130106
Audit Report No. E-2007/2013

Valid until 2016-06-27

TUV HELLAS (TUV NORD) S.A. Certification Body

Athens, 2013-06-28

This certification was conducted in accordance with the TUV HELLAS S.A. auditing and certification procedures and is subject to regular surveillance audits.



Certified excellence: exceeding international standards

Special attention is paid on every project detail – we consistently implement projects meeting the highest quality standards.

The company is certified with:

- **ISO 9001:2008:** Design, construction and installation of metal constructions.
- **EN 1090-1-2:** EXC 4 (Execution class up to 4) of steel structures and aluminum structures – **quality level prerequisite for C.E.**
- **ISO 3834-2:** Quality requirements for fusion welding of metallic materials.



EC CERTIFICATE OF FACTORY PRODUCTION CONTROL
 Nr.: 0654-CPD-0150

In compliance with Council Directive 89/106/EEC of 21 December 1988 on the approximation of laws, regulations and administrative provisions of the Member States relating to construction products (the Construction Products Directive or CPD), as later amended, it has been stated that the construction product

Manufacturing of steel structural components class EXC4 (acc. to EN 1090-2) and welding with processes 111, 121, 123, 135, 136, 783 and basic materials S235 - S355 & stainless steels X6CrNiMoTi17-12-2 (responsible welding coordinator Mr. D. Pitteris) as per Annex which is integral part of this certificate

placed on the market by

LYKOMITROS STEEL SA
ANO SPARTIA
385 00, SESKLO MAGNISIAS, GREECE

and produced in the factory

LYKOMITROS STEEL SA
ANO SPARTIA
385 00, SESKLO MAGNISIAS, GREECE

is submitted by the manufacturer to the initial type-testing of the product, a factory production control and to the further testing of samples taken at the factory in accordance with a prescribed test plan and that the notified body No. 0654 - TÜV HELLAS S.A. has performed the initial inspection of the factory and of the factory production control and performs the continuous surveillance, assessment and approval of the factory production control.

This certificate attests that all provisions concerning the attestation of factory production control described in Annex ZA of the standard(s)

EN 1090-1:2009+A1:2011

This certificate was first issued on 27.06.2013 and remains valid as long as the conditions laid down in the harmonised technical specification in reference or the manufacturing conditions in the factory or the FPC itself are not modified significantly and latest till 26.06.2016.

Date: 27.06.2013



Product Certification
 Cert. No 31



Partial reproduction of this document is prohibited

Headquarters - Athens: 282, Mesogeion Ave. 155 62 Chalkidiki, Tel. ++30-210-6540195, Fax ++30-210-6528025, e-mail info@tuvhellas.gr

TUV Code: 0805383

ANNEX OF EC CERTIFICATE OF FACTORY PRODUCTION CONTROL
 No. 0654-CPD-0150 dated 27-06-2013

WELDING CERTIFICATE

According to EN 1090-1, table B.1, the following data form a Welding Certificate which is an annex to the EC Certificate of Factory Production Control 0654-CPD-0150

Manufacturer	LYKOMITROS STEEL SA
Factory	ANO SPARTIA 385 00, SESKLO MAGNISIAS, GREECE
Standard	EN 1090-2:2008+A1:2011
Execution classes	Up to EXC 4 according to EN 1090-2:2008+A1:2011
Welding process(es)	111, 121, 123, 135, 136, 783
Basic material(s)	S235, S275, S355, X6CrNiMoTi17-12-2
Responsible Welding Coordinator	D. G. PITTERIS (EWI)
Valid since	27/06/2013



Product Certification
 Cert. No 31



Partial reproduction of this document is prohibited

Headquarters - Athens: 282, Mesogeion Ave. 155 62 Chalkidiki, Tel. ++30-210-6540195, Fax ++30-210-6528025, e-mail info@tuvhellas.gr

TUV Code: 0805383



CERTIFICATE

This is to certify that the company

LYKOMITROS STEEL SA

10 Km Volos - Larissa
38500 Ano Spartia/Sesklo, Greece

has been verified and recognized
as welding workshop in product range of

steel structures

based on the requirements of the standard

EN ISO 3834-2 (EN 729-2)

Certificate No: TH-160/13
TUV HELLAS Order No: 02.10.37

The range of validity and details of the inspection can be seen in our

Report No.: TH-160/13

(This certificate is valid in conjunction with the Report mentioned)

The company is using a quality assurance system,
technical equipment, qualified personnel and procedures for joining processes
for manufacturing and testing of welded products

This certificate is valid until 29.03.2016

Place, Date
Responsible for Certification



Thessaloniki, 29.03.2016
P. DAENIS
Manager Industrial Inspections
Thessaloniki & Thessalia Offices

Headquarters
TUV HELLAS (TUV NORD) S.A.
382, Mesogeion Av. 155 62 Cholongos - Greece
Phone: +30-210-6242195 Fax: +30-210-6528025
info@tuehellas.gr www.tuehellas.gr





Volos: a historic industrial town

Our factory is situated in the outskirts of Volos, Greece.

The strategic location of our facilities enables us to provide high quality logistic services. The distances from our factory, **are 9 km from the Port of Volos** and **12 km from the airport**, while road transport (national highway) is 1km away.

The city of Volos combines the allure of the sea with mystical mountain charm - it is a coastal port city in Thessaly situated midway on the Greek mainland, about 326 km north of Athens and 215 km south of Thessaloniki. With population of 150,000 Volos is an important industrial centre, while its port –Greece’s 3rd largest- provides a bridge between Europe, the Middle East and Asia.



We honor our customer's trust by implementing projects without any discount on the quality standards.

- **Engineering - Design**
- **Fabrication**
- **Installation**

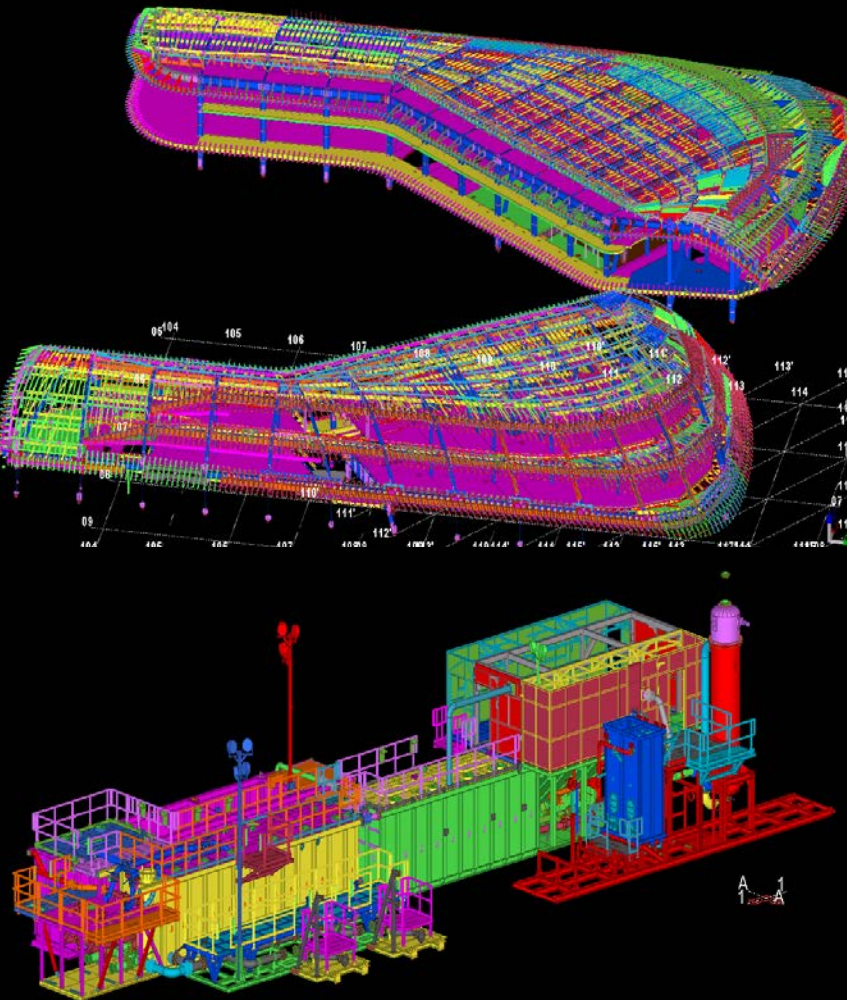

Engineering - Design



Design is performed by LYKOMITROS STEEL qualified & experienced designers using the Building Information Modeling software TEKLA, SAP, RSTAB.

With TEKLA, Lykomitros Steel structural engineers are enabled to create accurately detailed, highly constructible 3D structural models - regardless of material or structural complexity as follows:

- Detail Design (static calculations)
- Design of bolt connections (nodes)
- Design 3-D model in Tekla software in order to prepare shop-installation drawings (BIM)

A complete package of all the structural drawings (as built) -including all details - is at the customer's disposal before and after the start of fabrication.

After the client's approval, the software provides Data output for CNC machines, thus eliminating human error during the industrialization of the project.



Fabrication

Our chartered engineers – with the overall supervision and coordination of the project - are specialized in building and bridge steel constructions.

Fabrication and welding is in accordance with the highest international standards and all phases are monitored by our established quality systems.

A quality plan is formed and it is submitted to the client for approval. During the programming of the material cutting and the assembly, dimensional tests take place.

All welds are performed by qualified welders (EN287-1) with semi-automatic MAG welding machines, according to the project's specifications and tolerances. The assembly of custom cross section beams (main girders and connection beams), is executed on the automatic welding machine (height 3,3 m x width 1,25m) following by the weld of the machine to the desired welding thicknesses. The pre-camber of the main of the cross section beams (whenever it is necessary) is going to be given by their web which is going to be cut to the exact figure. The flanges of the cross section beams through the use of the welding machine's vertical pressure application will follow the web and give the desired pre-camber. The transversal hydraulic plungers will ensure the verticality of the web to flange welds avoiding any distortions during this process. Dimensional and visual inspection follows up after the weld according to DIN 18800-7, EN 1011-2, DIN EN 1090-2 (D2 Class 2), Assembly Procedure (OE_3) and Assembly Parts Application Instruction.





Installation

The method of installation is studied and planned per project.

LYKOMITROS STEEL's installations are executed in a safe, economical and efficient manner.

Installation is performed by specialized skilled work force with all required mechanical means (cranes, aerial platforms etc.). Senior Lykomitros engineers supervise the whole process throughout.

Lykomitros Steel S.A. preparing method statement for erection and a lifting plan of erection before the installation of the project.





Safety comes first!

Throughout our experience, there are some general practices that have been proven sound over the years:

- The structures must be planned to be unloaded and arranged close to erection points.
- Cranes are only released when all connection bolts are inspected for their tightness.
- All erector staff attends induction training prior to commencing work, where the supervisor engineer analyzes the project hazards and risks.
- PPE equipment is provided and its use is compulsory. In case of required roofing works safety nets are installed.
- A meeting is held at the start of every shift to analyze the work to be done, the hazards involved and the control measures in place to manage risks.
- Our company applies a strict safety policy in the framework for in – factory as well as external work operations.
- Lykomitros Steel S.A. has product and public liability insurances concerning all scope of works and cycle plant operations.

Capacity to deliver scale projects

LYKOMITROS STEEL maintains modern facilities, with a total area of 40,000 m², 13,500 m² are covered.

The facilities include:

- Automatic sand blasting machine (pre-heating sand blasting - painting system) with width of 2,50 meters
- Covered assembly area used for the assembly of structures
- Closed Painting section (Coating area)
- Storage area of 2,000 m² for ready-painted products
- CNC Machines
- Assembly – Welding – Painting area
- Mock up area (pre assembly for domes, rigs and tank systems)



The Production Capacity is up to **1,500 tons per month** in normal shift hours and the crane lift capacity per room is 100 tons.

The company's units use state of-the-art equipment and follow the most advanced methods of quality control. We number **170 FTE employees**, aiming to reach 200 in the near future, of whom 25 are in management & administration and the rest work in production.

State of-the-art equipment



Function	Capability
Cross- Section Beam Operator	Equipment for the construction of cross beams
Automatic Submerged Arc Welding Machine	Welds plates and tubes regardless of the quality of the material
Drilling System V630	Three separate controlled drilling units - Can be equipped with feeder rolls or feeder truck - Designed for big size fabricators
CNC Cutting Corridor VB1050	Automatic cutting-piercing beams – automatic drilling carbide
Plate punching & Drilling System V250	V250 Plate punching machine
Punching & shearing System V550	Infeed system, suitable for flat and angle steel with a length up to 15m
CNC Cutting Machine ESAB	Oxygen – Plasma cutting machine for plates up to 200 mm
HACO Hydraulic Guillotine Shear	HACO Shear 12mm x 3000 mm
HACO Hydraulic Press Break	220 t Press Break with useful load 3600 m HACO House
Boring Machine	VEB UNION GERA, “FRITZ HECKERT” GBFKF150/1 Tischbohrwerk
Cylinder	BIKO 3-HCD
Bender – Pressing Machine - Pipping	Bending – Pressing and oxygen cutting machine
Lathe	TOS CELAKOVICE SN55
Crane Bridges	ABUS DONATI: Lifting capacity: 3.2t – 10t – 20t – 32t
Fork Lifts	COMBLIFT: Lifting capacity: 5t – 10t

Dynamism and Development

The demand of global steel construction projects is increasing in size and complexity.

We are well positioned to reciprocate our customer's trust, by implementing projects with the highest quality standards, on time and within the set budget.

We have successfully implemented challenging projects in many countries: Bridge projects, Duct Works, Power Plants and Oil & Gas Projects.



Customer	Aiolos ATE
Location	- LARISSA, GREECE
Quantity	450 tns
Technical Characteristics	-Pedestrian Bridge, Continuous Multi Span, Max Span 32m
Scope Of Works	-Fabrication -Special Transportation -Installation



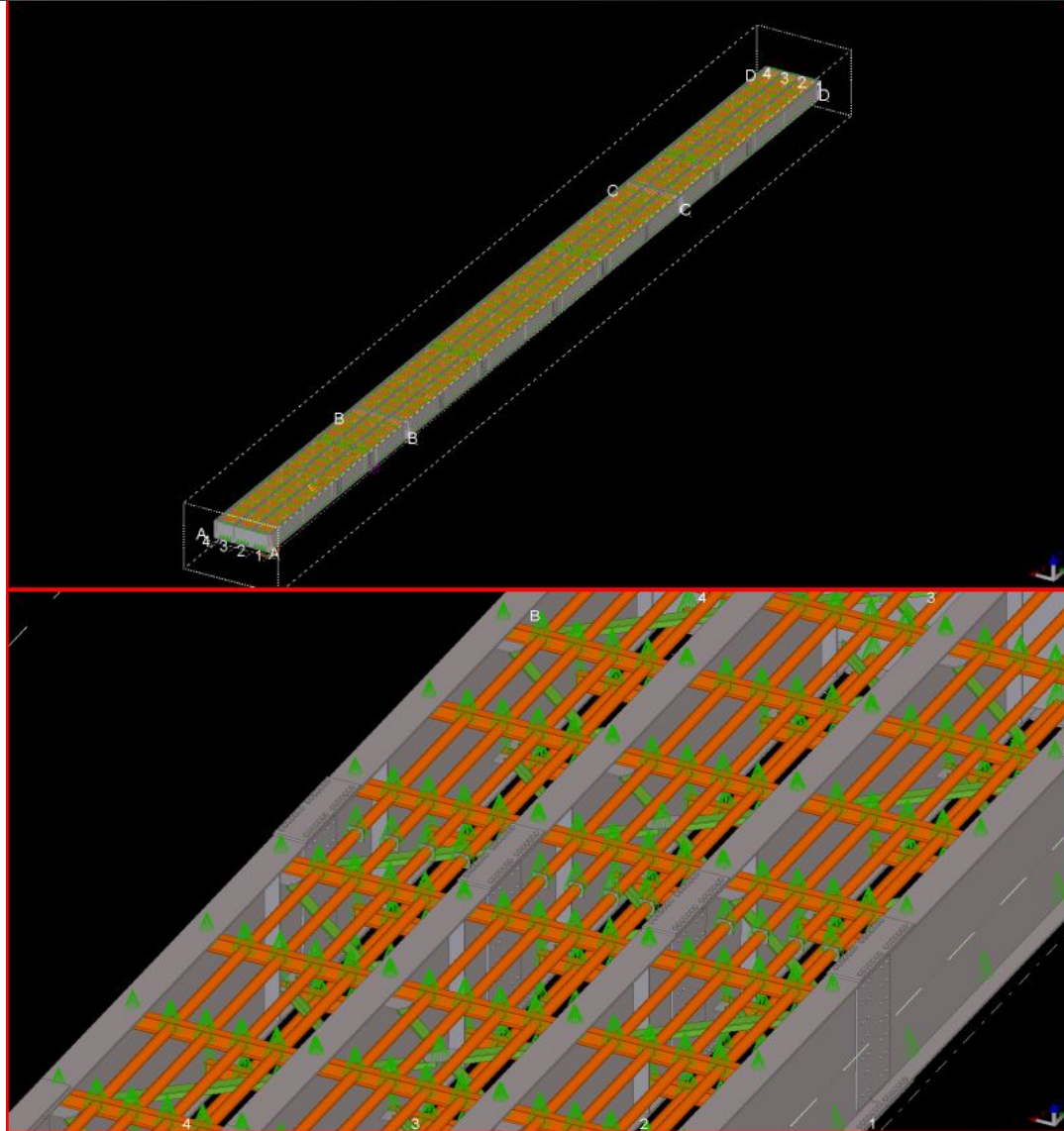

Customer	Aktor S.A
Location	- GREECE
Quantity	80 tns
Technical Characteristics	- Secondary Road Bridge, Single Span Bridge 16m
Scope Of Works	-Fabrication -Special Transportation -Installation



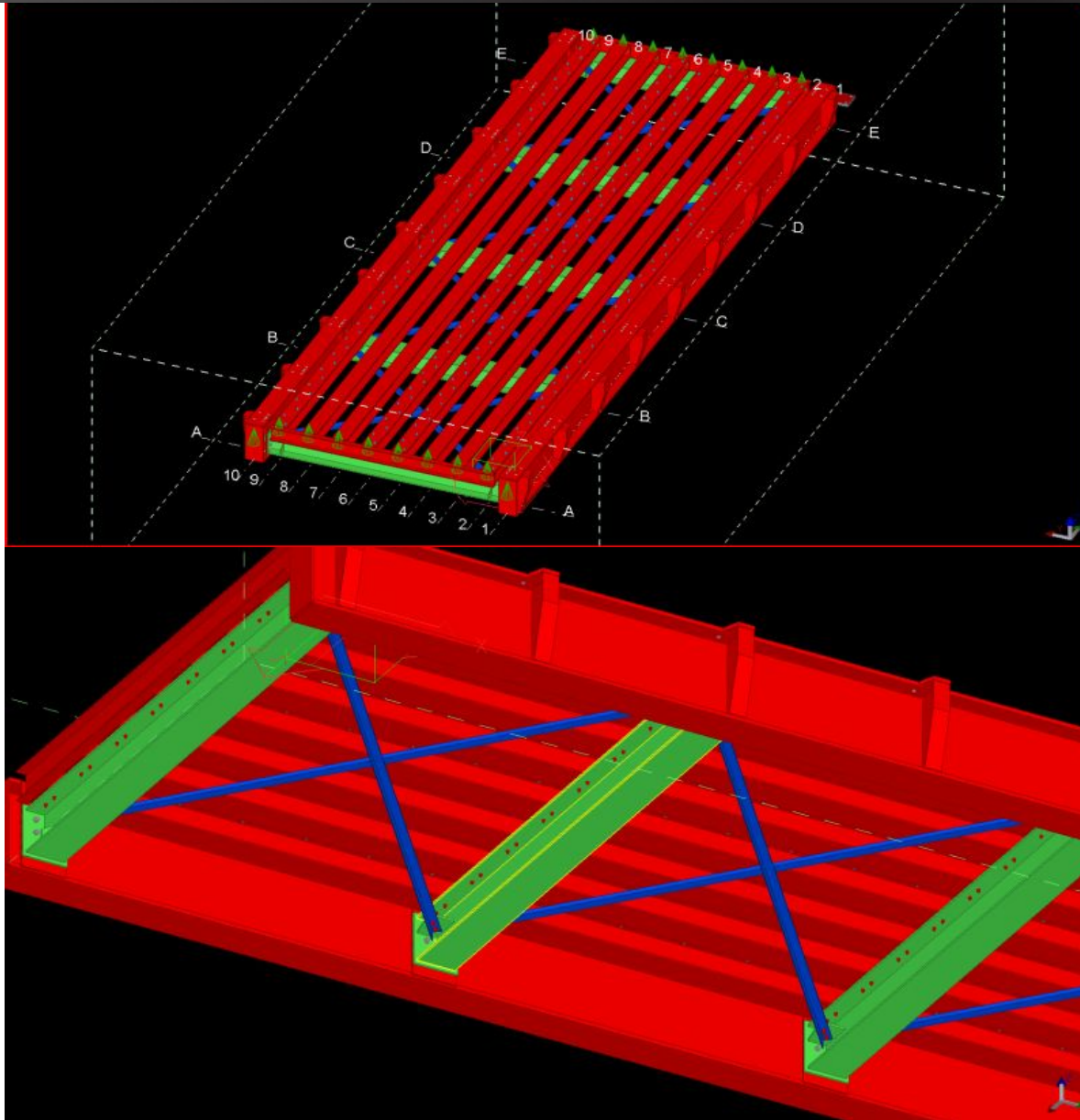

Customer	Elemka SA
Location	Greece - Ikonio
Quantity	1700 tns
Technical Characteristics	-High Speed Railway Bridge -Cable suspended Arch -Main Span: 120m
Scope Of Works	-Engineering -Fabrication

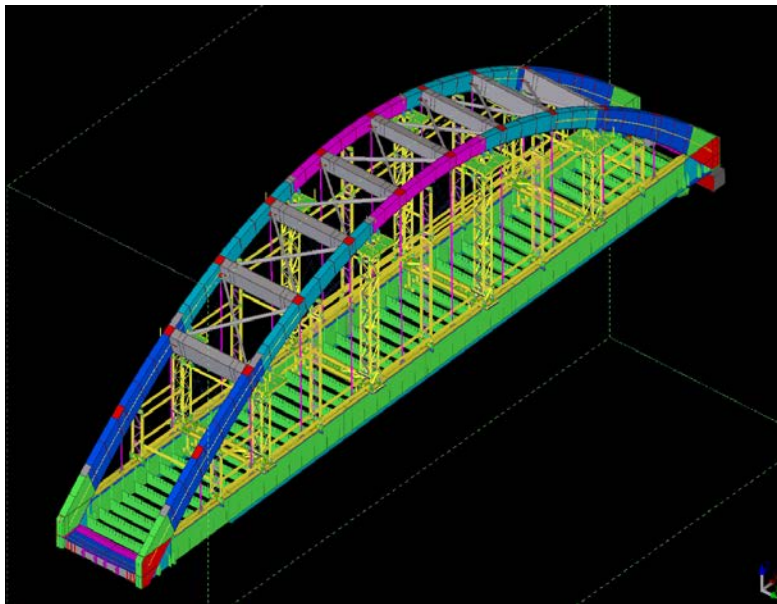

Customer	Elemka SA
Location	Greece
Quantity	80 tns
Technical Characteristics	Road Bridge, Single Span Bridge 30m
Scope Of Works	-Engineering -Fabrication

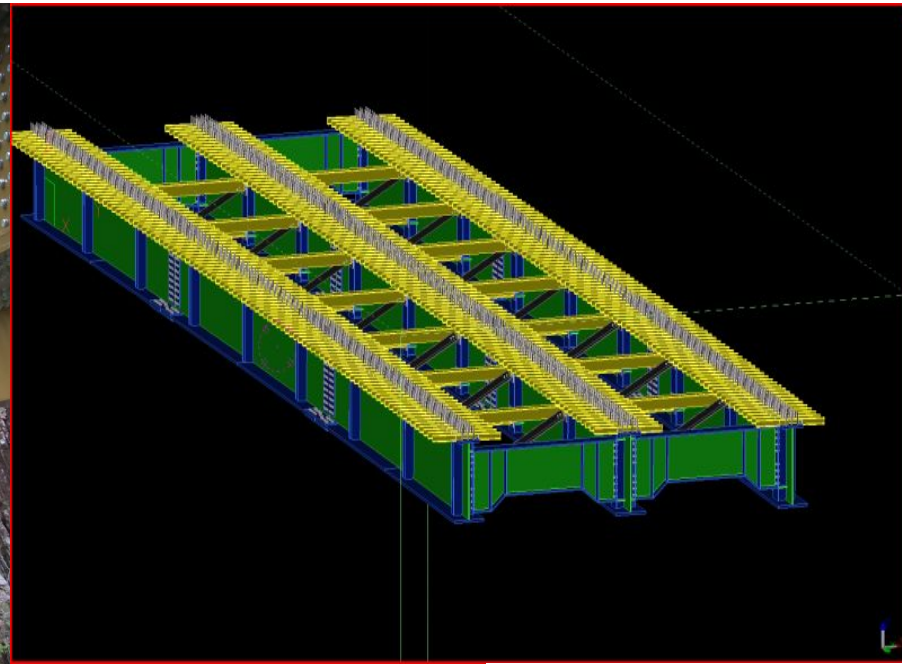



Case Stories

HEMPADUR FAST DRY 15560, HEMPADUR MASTIC 45880, HEMPATANE HS 55610

Ikonio Bridge

Hempel system provides bridge ISO 12944 protection

A 110-meter arch truss bridge on the railway connecting Greece's port of Piraeus with the new logistics centre at Thrasio Pedio was assembled 24 meters distant from where it belonged. It's not that the engineers got their measurements wrong. They had planned it that way.

The bridge, which is the longest of its type in Greece, is painted with a 5-coat system designed by Hempel to meet ISO 12944 requirements for category C5-I protection. It is comprised of **HEMPADUR FAST DRY 15560** (1 x 80 µm), **HEMPADUR MASTIC 45880** (2 x 80 µm), and **HEMPATANE HS 55610** (2 x 80 µm).

Erecting the bridge had to account for many factors, explains Athanasios Aronis, project manager at ELEMKA S.A., the general contractor. Among others, it had to consider the site's difficult accessibility and limitations on interrupting traffic on the under-passing road.

"The most convenient way to meet all the requirements," Mr. Aronis relates, "was to construct the bridge on a temporary site parallel to the crossing span so that once the bridge construction was completed it could be slid into its final position."

LYKOMITROS STEEL S.A. of Volos and DS ISKRA S.A. of Kumanovo were subcontractors for steel fabrication. Completed in late 2009, the bridge was coated with about 6,500 litres of Hempel paints.

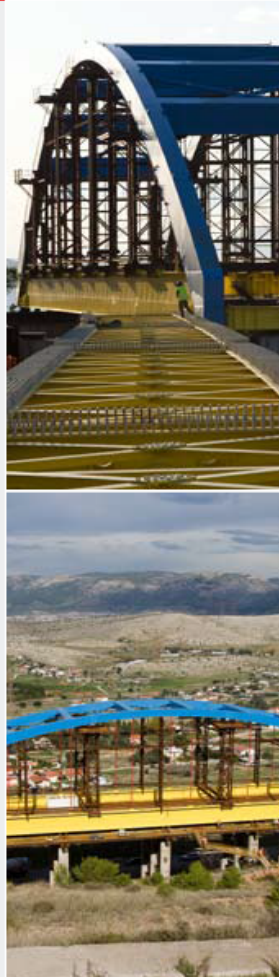

ELEMKA S.A.
TRADING AND CONSTRUCTION COMPANY

02/05/2011

To whom it may concern

CERTIFICATION OF WORKS

We certify that LYKOMITROS STEEL S.A. was assigned to fabricate and successfully executed, according to the technical specifications, the steel structure of the railway bridge in Ikonio-Athens. The total amount of the works was 2.300.000 €.

For ELEMKA S.A.

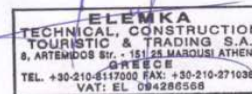

HEMPEL (UK) LTD.
Llantarnam Industrial Park
Gwent NP44 3XF Cwmbran
Tel: +44 (0)1633 874024
Fax: +44 (0)1633 489089
E-mail: sales.uk@hempel.com
www.hempel.co.uk

8, Artemidos St., 151 25 Maroussi, Greece • TEL: +30-210-811.7000 • FAX: +30-210-27.10.362
<http://www.elemka.gr>, E-mail: info@elemka.gr



TO WHOM IT MAY CONCERN

13/02/2012

CERTIFICATION OF WORKS

We certify that LYKOMITROS STEEL S.A. was assigned at 15/01/2011 to fabricate steel constructions for the DEIR ALI II - power plant in Syria.

All deliveries have been checked and were within the required technical specification.

The delivered total weight counted up to **3000tns.**



Anestis Chatzipanagiotidis
General Manager

Customer	Vinci Construction Grands Projects SAS
Location	Greece – Kamares Bridge
Quantity	980 tns
Technical Characteristics	-Double Span Bridge 130m
Scope Of Works	-Engineering & Design -Fabrication -Installation

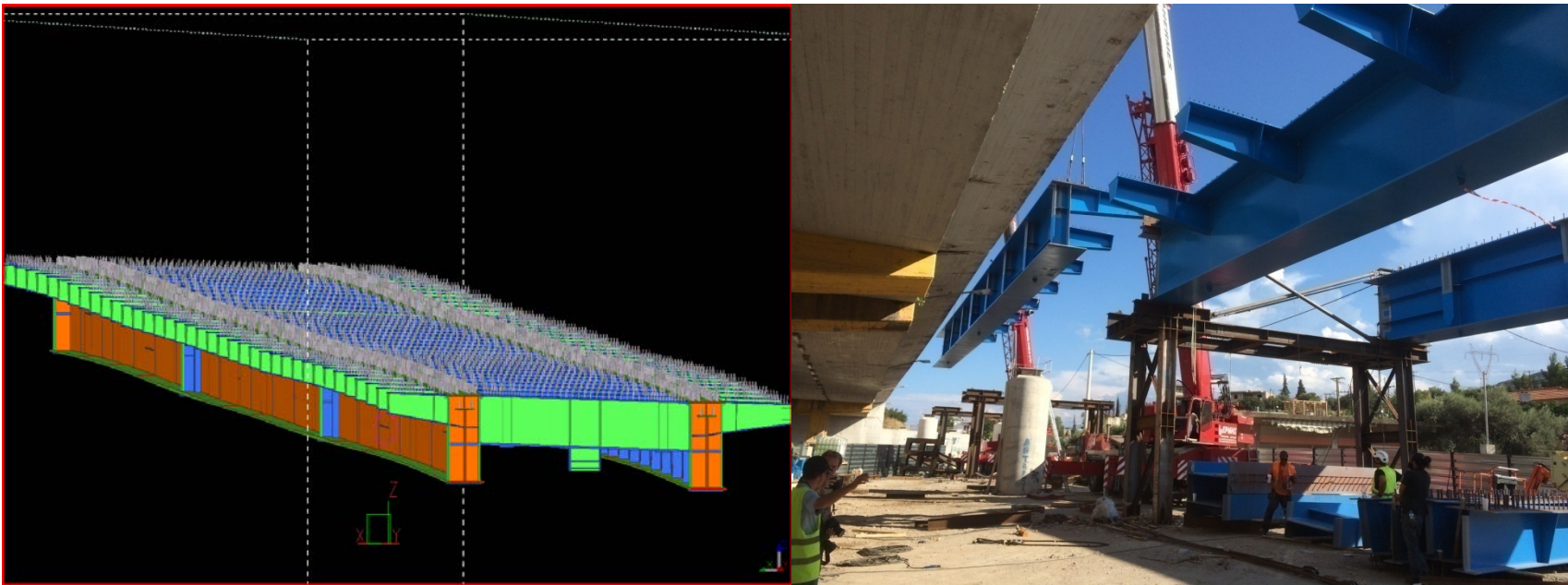



VINCI
CONSTRUCTION

GRANDS PROJETS

EKPPT Motorway Project

Drepano, 26th April 2011
Ref: TOE/JSC/ADO/SUB/L/2011/003574

To : **LYKOMITROS STEEL A.E.**
Ano Sparta, SESKLO VOLOU, P.O Box 38500, GREECE
Tel. 24210 96739 / Fax. 24210 96729
Attn. Mr LYKOMITROS Vassilis – C.E.O

Subject : Bridge composite deck- steel structure works reference

Dear Sir,

I hereafter confirm that Company LYKOMITROS STEEL A.E did execute for VCGP the factory fabrication of our "Kamares" composite bridge full welded steel structure. The contract represented 500T of S355 steel with FCAW welding process with gas (n°136)

These steel works have been performed in 2010 with high respect of latest European standards, right in targeted schedule and contract price.

Assembled parts passed successfully the inspections of Bureau Veritas Greece, VCGP and SETEC Paris Experts.

I will not hesitate to tender again LYKOMITROS STEEL A.E. company for any similar project.

Yours sincerely,
VCGP

JS CLOITRE
Site Manager

Internal Distribution....P. MORAND, Project Manager

Page 1 / 1

Vinci Construction Grands Projets
Drepano, Rion – 26504 RION, PATRAS
☎ 2610 961 200 * Fax. 2610 910 365



For the packing:

- Chocks and packaging corners are placed between the structures in order to eliminate collision
- The structures are wrapped with protective cell air
- Metallic galvanized special strips are covering the package



Storage,
ready
package
for
loading

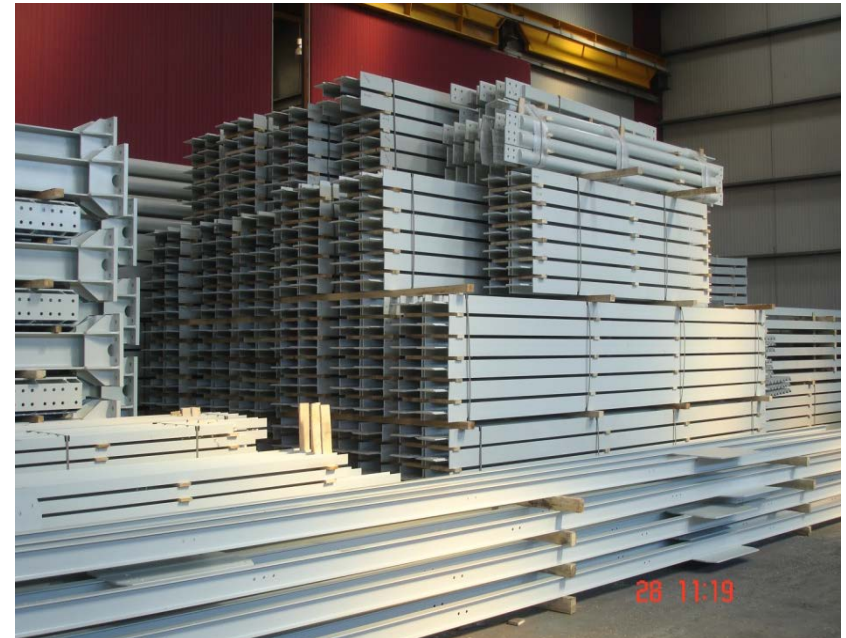

By Truck



By Vessel



Partnerships with the best

We work closely with our global partners, to understand unique project needs and develop tailored proposals to specific market demands.

Our global network is supported by some of the biggest construction companies: in Greece, among others, we have implemented projects with AKTOR, METKA & TERNA, while abroad with E.ON, BENTEC & TAIMWESER, SEELE, FLSMIDTH, BUGGING - UDDEMANN.

Our partners are key to our development and success - working together we create value and provide end-user customers with highly competitive solutions.





LYKOMITROS STEEL S.A.

STEEL CONSTRUCTIONS ENGINEERING

Ano Spartia, Sesklo, Volos, Greece

Tel.: (+30) 2421096739 Fax (+30) 2421096729

Email: info@lykomitros-steel.gr

www.lykomitros-steel.gr